

T8 LED TUBE - 6CCT TUNABLE & ADJUSTABLE WATTAGE

DESCRIPTION:

The T8 LED Tube series is an energy-efficient replacement for traditional T8, T12, and T5 fluorescent lamps, offering superior performance, durability, and flexibility. Designed for both direct wire and ballast-compatible applications, this tube light provides excellent illumination while reducing energy consumption by up to 50%. Its high-quality aluminum and polycarbonate construction ensures effective heat dissipation and shatter resistance. With tunable color temperature and adjustable wattage options, this LED tube offers maximum versatility for various lighting needs.

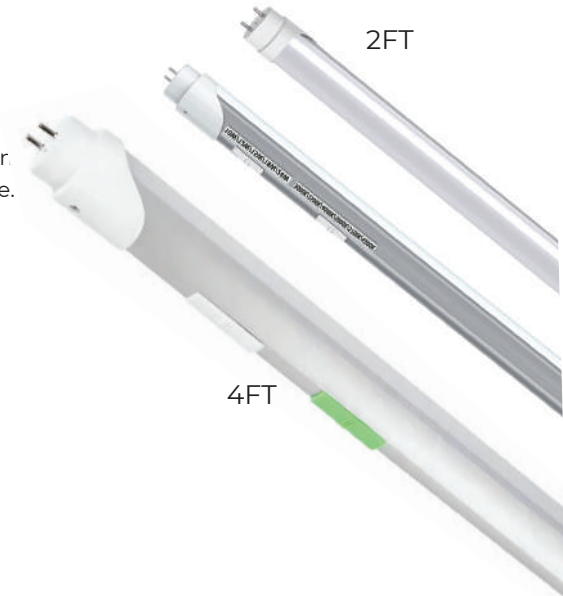

FEATURES:

- 6CCT tunable for customized lighting.
- Adjustable wattage for optimized energy consumption.
- Aluminum housing with a polycarbonate lens for uniform light distribution.
- High efficacy up to 170 lm/W.
- Compatible with both ballast and direct wire installation.
- Mercury-free and UV-free, ensuring an eco-friendly lighting solution.
- Rated for up to 50,000 hours of operation with minimal maintenance.
- Available in 2FT and 4FT lengths.



APPLICATIONS:

- Commercial office buildings
- Retail spaces
- Industrial warehouses
- Schools and universities
- Hospitals and healthcare facilities
- Parking garages and basements

TECHNICAL SPECIFICATIONS:

Length Options	2 ft	4 ft
Adjustable Wattage	6W/8W/10W/12W/15W	22W/20W/18W/15W/12W/10W
Input Voltage	AC 100-277V	
Color Temperature (CCT)	3000K, 3500K, 4000K, 5000K, 5700K, 6500K	3000K, 3500K, 4000K, 5000K, 6000K, 6500K
Luminous Flux	125LM/W - 170LM/W	120LM/W-140LM/W
CRI	>80	
Beam Angle	120°	
Base Type	G13	
Working Temperature	-4°F to 104°F	
Material	Aluminum + Polycarbonate	
Rated Lifetime	50,000 hours	
Certifications	UL, CE, RoHS	
Environment	Dry, Damp	
Warranty	3 Years	5 Years

PRODUCT STRUCTURE:

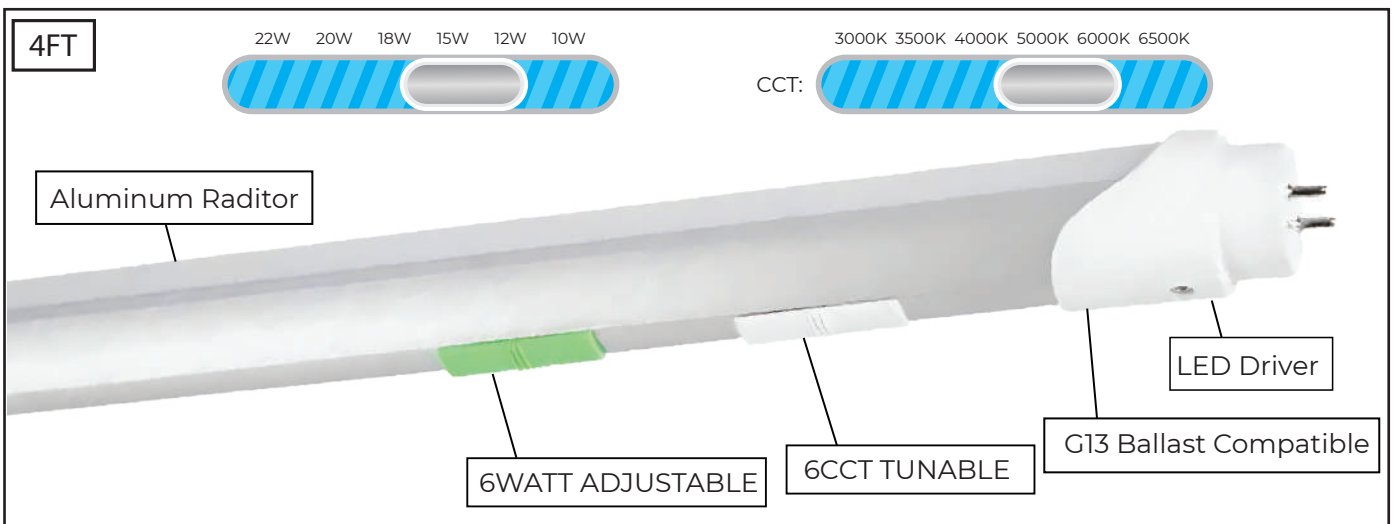
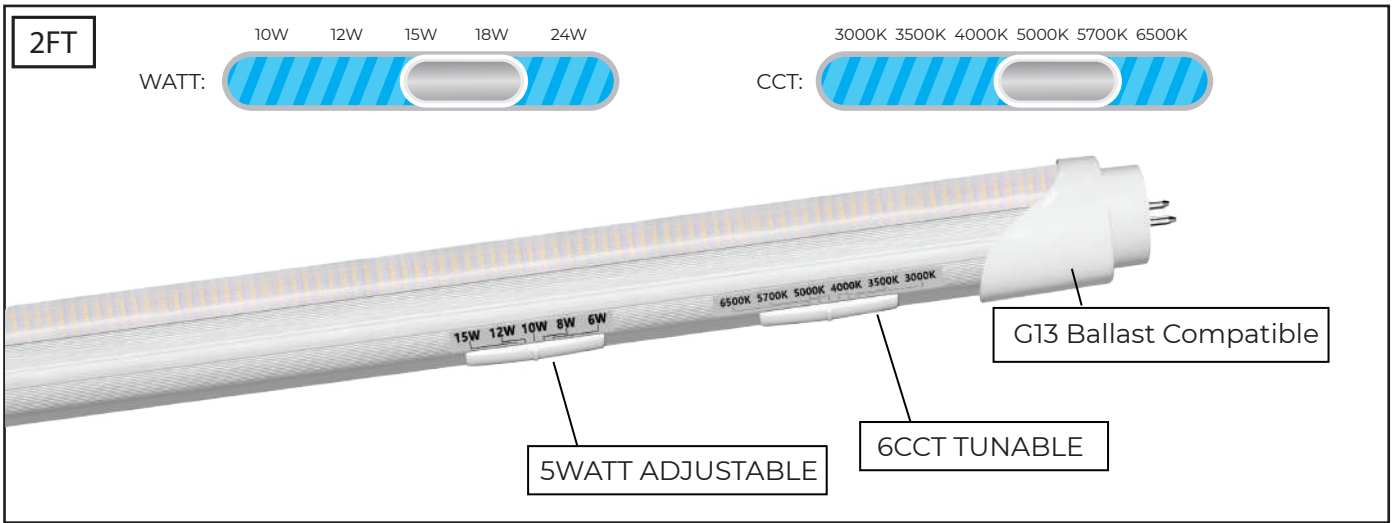

DIMENSIONS:

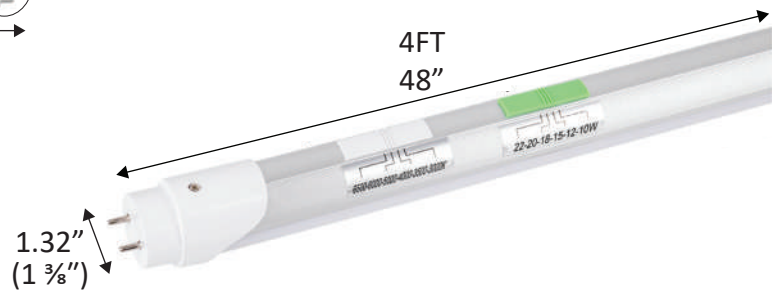

INSTALLATION GUIDE:

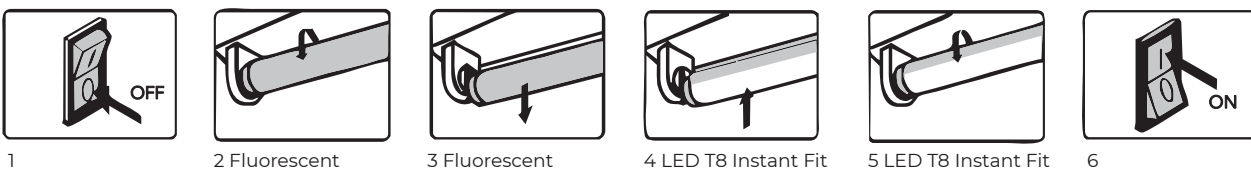

PLUG-AND-PLAY INSTALLATION INSTRUCTIONS:

1. Ensure the power is switched off before beginning installation.
2. Remove the diffuser, if present.
3. Take out the fluorescent tubes and dispose of them responsibly, as they contain hazardous mercury.
4. Insert the LED tube into the fixture.
5. Secure the LED tube and replace the diffuser, if applicable.
6. Restore power to complete the installation.

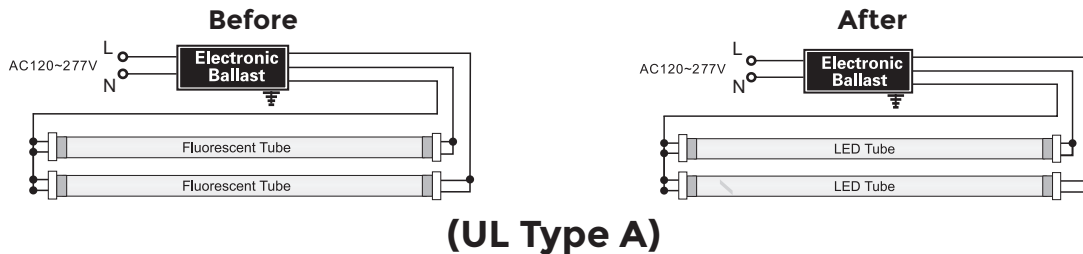

RETROFIT INSTALLATION INSTRUCTIONS:

1. Turn off the power supply to the fixture.
2. Detach the diffuser, if applicable.
3. Carefully remove the existing fluorescent tubes and dispose of them according to hazardous waste guidelines.
4. Follow the provided wiring diagram to cut and adjust the wires.
5. Connect the new wiring to the branch circuit as shown in the diagram.
6. Cover the wiring channel securely.
7. Install the LED tube and replace the diffuser, if necessary.
8. Restore power to the fixture.

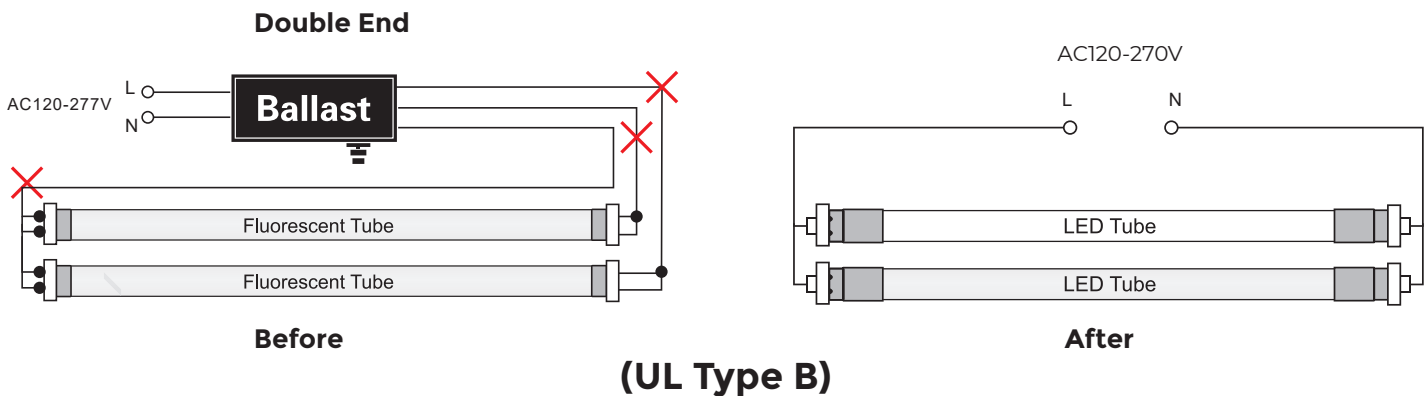

IMPORTANT WARNINGS:

1. Installation should only be performed by a licensed electrician.
2. These lamps are designed for indoor use in damp or dry locations only. They are not suitable for wet locations.
3. Ensure that the lamp holders (tombstones) are in good condition and free from defects before installation.
4. Verify that the ballast brand and model are included in the compatible ballast list provided by the manufacturer.
5. Confirm that the ballast is functional and under warranty before proceeding with installation.
6. Insert the LED tube pins correctly into the socket to ensure proper installation.
7. These lamps are not suitable for use in emergency exit fixtures.
8. Avoid using these lamps with light dimmers unless they are compatible with dimmable ballasts (UL Type A).
9. The manufacturer is not responsible for any damage to the product or property resulting from improper installation. Refer to the installation instructions provided for proper guidance.

ORDERING GUIDE:

SKU: T8-2FT-6CCT-CLR			
Item	Size	Color Temperature	Cover
T8	2FT	6CCT (3000K, 3500K, 4000K, 5000K, 5700K, 6500K)	FRS
	4FT	6CCT (3000K, 3500K, 4000K, 5000K, 6000K, 6500K)	CLR