

# DOUBLE WIDE SQUARE RECESSED ALUMINUM CHANNEL

## DESCRIPTION:

This Double Wide Square Recessed Aluminum channel is designed for installing LED strip lights of 0.79 inches wide in various settings. This aluminum channel with silver anodized surface provides a sleek lighting solution. Constructed from high-quality Aluminum 6065-T5, it efficiently dissipates heat to extend the lifespan of LED lights. A durable plastic cover ensures even light distribution. This product is ideal for both commercial and general indoor lighting applications.

## FEATURES:

- Constructed with durable 6065-T5 aluminum for long-lasting performance.
- Includes a diffused polycarbonate cover for even light distribution.
- Accommodates LED strips up to 0.79 inches wide for flexible lighting options.
- Silver anodized finish enhances corrosion resistance and aesthetics.
- Trimless recessed installation for a sleek and modern appearance.

## APPLICATIONS:

- Residential and commercial indoor lighting installations.
- Architectural and decorative lighting.
- Retail displays, shelves, and showcases.
- Accent and task lighting for offices or home spaces.

## TECHNICAL SPECIFICATIONS:

Material	6065-T5 Aluminum
Diffuser Cover	Polycarbonate (PC) diffused cover (sold separately)
Length	6.4 ft
Weight	0.31 lbs/ft
Maximum LED Strip Width	0.79 inches
Beam Angle	130°
Finish	Silver anodized
Installation	Trimless recessed

## DIMENSIONS:

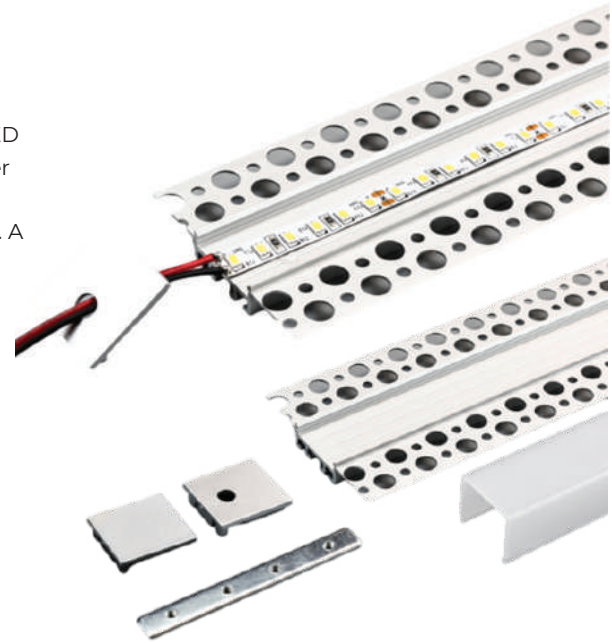
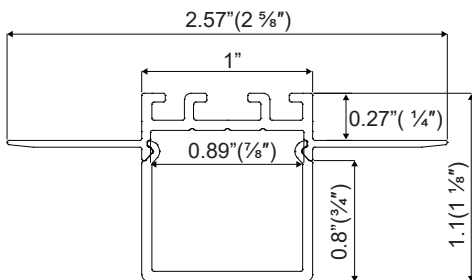

**ACCESSORIES (SOLD SEPARATELY):**

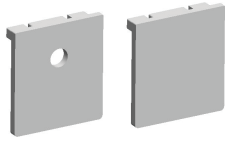

End Caps  
SKU: AE-110-CAP



Cover  
SKU: AE-110-CVR-2M



180° Connector(Metal)  
SKU: AE-CONN-180°



90° Connector(Metal)  
SKU: AE-CONN-90°



90° Vertical Connector (Metal)  
SKU: AE-CONN-V-90°

**STEPS OF INSTALLTION:**

<p>1. Attach end caps.</p>	<p>2. Mount the profile to drywall.</p>	<p>3. Apply plaster for a seamless finish.</p>
<p>4. Paint the fixture and drywall.</p>	<p>5. Install the LED strip.</p>	<p>6. Snap on the diffused cover.</p>
<p>7. Complete the installation.</p>		