

AC Strip Working Instruction

1 Preparation

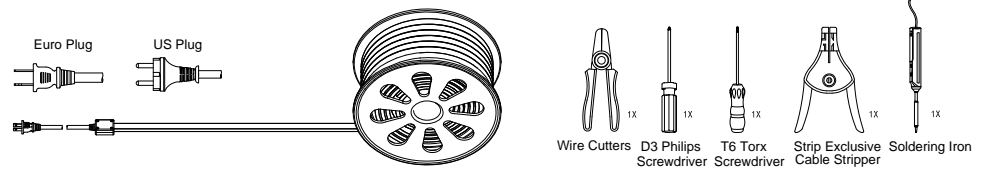

2 Length Calculation

L: Total Length
 Lb: Emitting Length
 N: Quantity
 La: Strip Length
 L1: Min. Cuttable Length

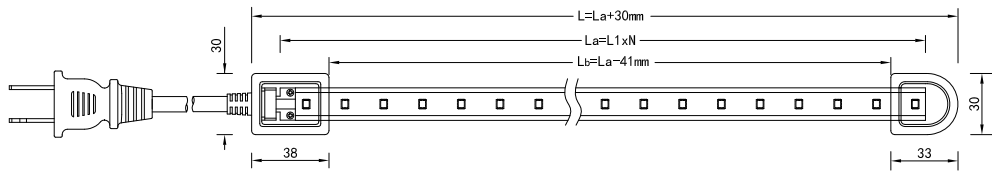

3 Cutting

$$L1 = \textcircled{1} - \textcircled{1} / \textcircled{2} - \textcircled{2}$$

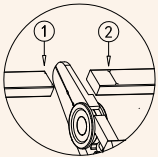

Strictly follow: be always cut on the line with same mark ① or ②, for the front and end terminal.

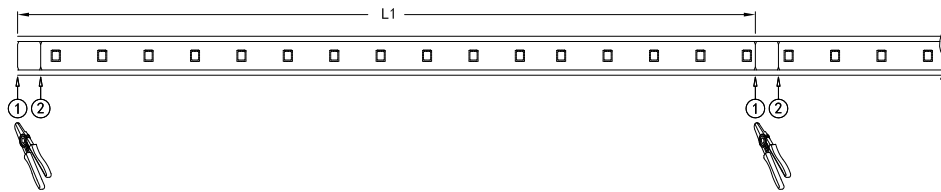

4 Wire Stripping

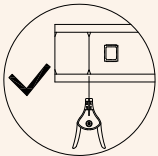

Aim at the cutting line

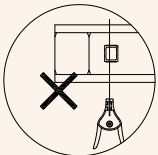

Not aim at the cutting line

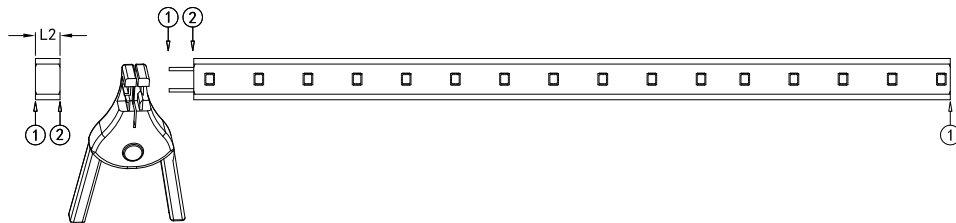
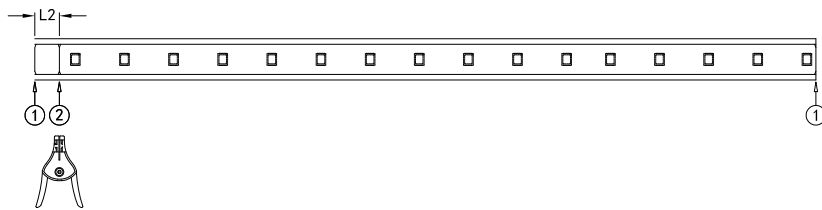

5 Tin Soldering

Note: Operated by professional worker, to avoid break for the main copper cable, while processing crimping by screw.

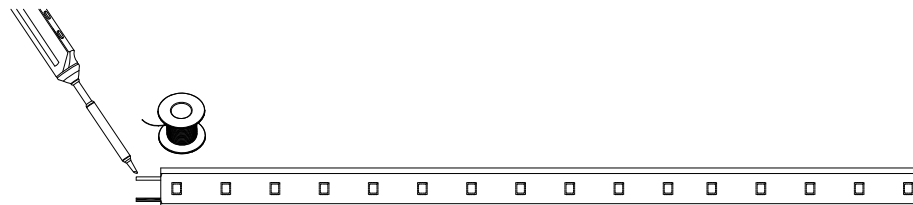

AC Strip Working Instruction

6 Anti-press Stand Fixing



Note: This stand is for LED protection against crimping, while fixed inside the cable box.

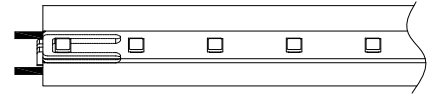
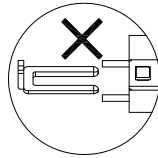
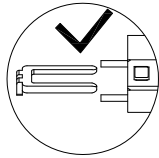

7 Cable Connection

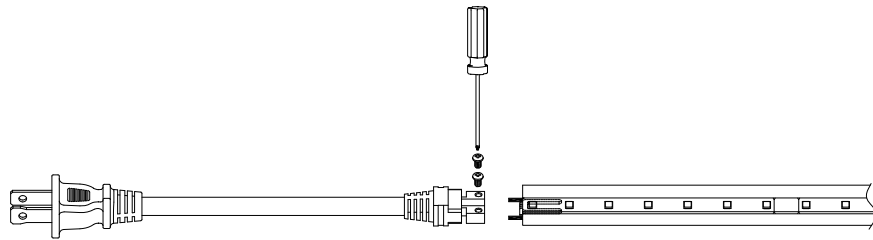

8 Cable Box & End Cap Fixing

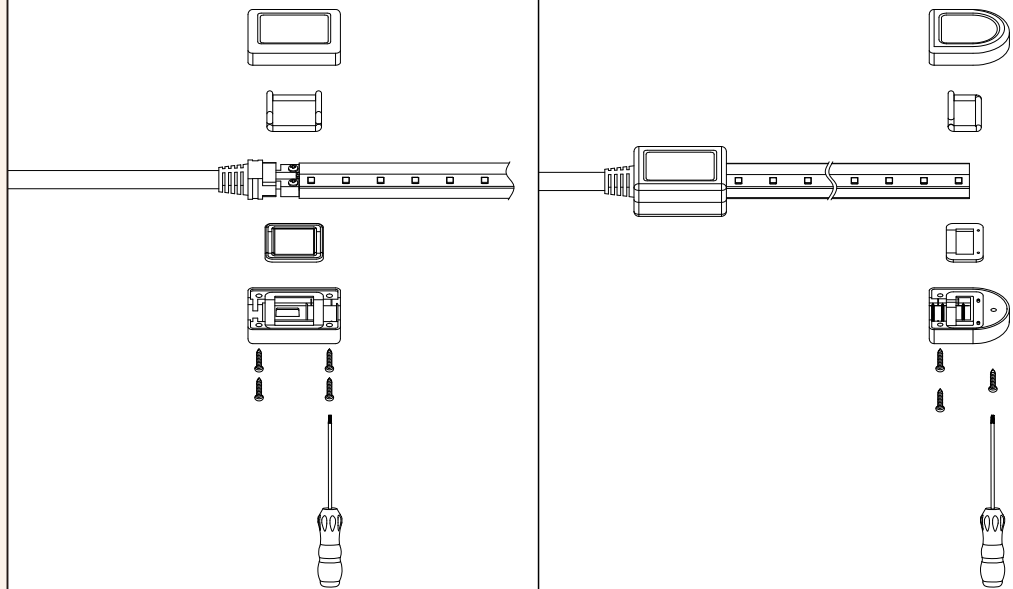
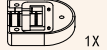

9 Complete

