

WIDE DEEP ALUMINUM CHANNEL

DESCRIPTION:

This Wide Deep Aluminum Channel is designed to be used with LED strip lights of 0.47 inches wide, providing a clean, smooth surface for LED strip lights to be adhered to. Made from high-quality Aluminum 1060/6063-T5, it features a silver anodized surface for enhanced durability and appearance. This is ideal for windows & counter lighting, display sides and many more.



FEATURES:

- Durable: High-grade aluminum ensures longevity and efficient heat dissipation.
- Versatile: Available in 3.2 ft and 6.4 ft lengths.
- Stylish: Sleek black or silver finishes.
- Soft Glow: Frosted cover for smooth, dot-free light diffusion.
- Compatible: Fits LED strips up to 0.47 inches wide.

APPLICATIONS:

- Window lighting
- Counter lighting
- Display cases
- In-ceiling decor lighting
- In-wall accent lighting

TECHNICAL SPECIFICATIONS:

Material	Aluminum 1060/6063-T5 & Polycarbonate (PC)
Surface Finish	Silver Anodized
Length	3.2ft , 6.4ft
Color Options	Black , Silver
PC Cover Options	Black , Frosted (Sold Separately)
Compatible LED Strip Width	Up to 0.47 inches (Optimal with 36 LEDs per foot)
IP Rating	IP20

DIMENSIONS:

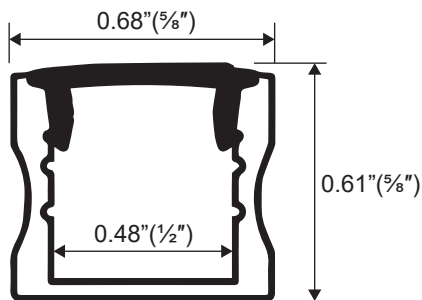

ORDERING GUIDE:

SKU: AE-1715-Uni Wide-1M			
Model	Color	Type	Size
AE - 1715 (Aluminum Extrusion)	Silver Black	Uni Wide	1M 2M

Note: Silver finish is available only in the 1M length.

ACCESSORIES:



Wide Deep Channel End Cap
SKU: AE-1715-CAP



Wide Deep Channel Cover
SKU: AE-1715-CVR-FRS-1M
AE-1715-CVR-BK-2M

SERVICE ENVIRONMENT AND INSTALLATION:

1. Can be installed using clips.

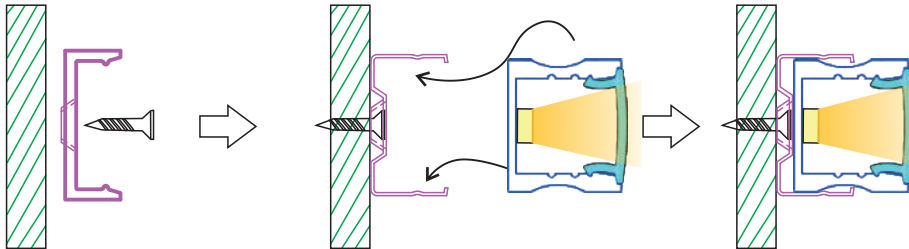

2. Can be installed using double-sided tape.

